

Sir Robert Helpmann Theatre – Mount Gambier

TECHNICAL FACILITIES



10 Watson Terrace, PO Box 899 Mount Gambier, SA 5290

Box Office: (08) 8723 8741, Administration: (08) 8723 8743, Fax: (08) 8723 8744

Email: helpmann@countryarts.org.au / Web: www.countryarts.org.au/helpmann

Manager: Frank Morello, Technical Manager: Fay Cakebread

Seats

Stalls	366
Balcony	150
Boxes	8
TOTAL SEATING	524
Total possible seating with thrust stage or orchestra pit in use - minus 38 seats	486
Total possible seating with sound desk placed in auditorium – minus 12 seats	516

The theatre can cater for up to 4 wheelchair seats

Country Arts SA reserves the right to withdraw from sale for any performance, a maximum of 8 seats. Therefore above capacities may reduce by 8.

Proscenium

Width	10.4m (34feet)
Height	7.3m (24feet)
Adjustable Proscenium	
Width maximum	10.4m (34feet)
Height maximum	7.3m (24feet)
Height minimum	5.0m (16feet)

Stage

Depth	12.3m
Front of stage to curtain line	1.3m
Front curtain line to rear wall	11.0m
Front curtain line to front of forestage Lift centre	3.9m
Width: extent of timber stage	20.0m
From centre line to stage left	9.5m
From centre line to stage right	10.5m
Including wings	22.0m
Between fly galleries	16.0m
Height: to underside of grid	18.0m
To underside of fly galleries	8.0m
Front row of stalls above	.9m

Stage Surface

Unraked timber stage (Pinus Radiata) faced with masonite
--

Orchestra Pit

Elliptical pit lift can be raised to stage level
12.0m wide and 2.1m deep at centre.
Lowers to a depth of 2.6m below stage level - capacity 15
Pit can be extended into sub-stage giving pit area
12.0m wide and 5.0m deep - capacity 40

Sub-Stage Area

11.7m wide and 9.4m deep - reduces to 11.7m wide and 6.6 deep when orchestra pit extension in use.

Scene Dock Area	Dock doors allows end loading with direct access for transport from side street	2.7m wide x 3.6m high
------------------------	---	-----------------------

Stage Drapes	Tabbs (draw curtains) (TC.75 heavy duty steel truss construction stage tracks)	9m high x 5m Wide	2 pair black
	Borders	2m high x 15m wide	4 pair black
	Legs	9m high x 2.2m wide	4 pair black
	Cyclorama	9m high x 15m wide	

Rehearsal Area	Directly at rear of stage. Timber floor, one wall mirrored, two walls fitted with ballet barres. 10.4m wide x 8.5m deep.
-----------------------	--

Wardrobe (Work Room)	Ironing board and iron, automatic washing machine, tumble dryer, worktable.
-----------------------------	---

Dressing Rooms	Number	Capacity	Amenities
	1	2	Shower and toilet
	2	4	Shower and toilet
	3	20	Shower and toilet
	4	20	Shower and toilet

Lecturn	National Panasonic
----------------	--------------------

Music Stands	24 x Music Stands with Lights
---------------------	-------------------------------

Pianos	1 Yamaha Model CF Concert Grand
	1 Yamaha Upright

Rostra	5 x 6" high x 4' wide x 6' long
	7 x 1' high x 4' wide x 6' long
	7 x 1'6" high x 4' wide x 6' long
	7 x 2' high x 4' wide x 6' long
	7 x 2'6" high x 4' wide x 6' long
	7 x 3' high x 4' wide x 6' long

Machinery	37 sets of single purchase counterweight lines
	Barrel-length 15.0m
	Operated from prompt stage level
	House curtain operates fly from P.S.
	Orchestra pit lift and thrust stage - screw jack operated

Elevated Work Platform

The theatre is fitted with a JLG model 20DVL elevated work platform to assist in rigging and focussing equipment above stage. The platform will elevate to 5.94 meters above stage level. Persons wishing to use this platform must produce their yellow Operator Training card as issued by the Elevating Work Platform Association of Australia as proof of training, before commencing work on the platform.

Lighting Equipment

Lighting Control System

ION 1000 lighting console
4 x encoders
10,000 control channels and cues
Universal fader wing 2 x 20 black for ION
2 x 19" TFT LCD monitors with resistive touch screens
Android tablet running ETC aRFR remote software
DMX 512 protocol
Softpatch and patch panel for system flexibility
72 x 2.5kw dimmers & 6 channels at 5k of LSC EKO dimmers

Spot & Floodlight Lanterns

2 x	Selecon Pacific 18PACFS80V Follow Spots
24 x	Model T/64 bifocal spots
16 x	Model T/84 zoom spots
24 x	Model 743 fresnel spots
40 x	Patt 23 MkII profile spots
5 x	Quartzcolour Pallas 4 Groundrow
5 x	Ianiro iris 4 cyc lanterns
16 x	Selecon 2kw fresnel spots
10 x	CCT 1kw fresnel spots
10 x	Selecon 650w fresnel spots
12 x	Selecon 25 to 50 degree zoom spots

Sound Equipment

Analogue sound desks	Control Console - Soundcraft GB4
	24 mic/line input 2 stereo input
	4 sub groups 8 auxiliary sends
Digital sound desk	Roland M400 Vmixer
	48 inputs/18 buses signal processing
	56-bit AD/DA Conversion 24-bit / 44.1kHz or 24-bit / 48kHz Network Latency 2.8 ms (typical)
	32 Track Live Digital recording direct from digital snake using Sonar 8 producer.
	(Client must provide external SATA hdd larger than 300GB formatted as NTFS)

Amplifiers	1 x Crown XLS 402
	4 x Crown XLS dual channel amplifiers
System controller	1 x Bose control Space ESP-88
	4 x TOA P150D Foldback Amplifiers
Foldback Speakers	6 x Australian Monitor Foldback Wedges
Speakers FOH	4 x Bose 802II and 2 x 502B low frequency subs - central cluster in front of proscenium
	2 x Bose 802II and 2 x Bose MB4 compact low frequency subs on left and right of stage
Play/Rec Equipment	1 x Denon DRM-555 Cassette Deck
	1 x Denon DR-MO7 Cassette Deck
	1 x Sony CDP 591 Compact Disc Player
	1 x Sony CDP-XE 270 Compact Disc Player
	1 x Sony DVD Player
Special Effects Rack	2 x Yamaha Q2031B dual 31 band Graphic Equalisers
	1 x Yamaha Rev 100 Digital Reverberator
Microphones	6 x Shure SM 58 Vocal
	4 x Shure Beta 58 A Vocal
	6 x Shure KSM Condenser
	6 x Shure EZ0/G Easyflex Overhead
	4 x Shure MX393/0 Wired Boundary
	1 x Mipro ACT - 707 Receiver
	4 x Mipro ACT - 707 HM Hand Held Radio
	4 x Mipro ACT - 707 TM Lapel Belt Packs
	4 x Mipro MV - 53L Lapel Radio
	3 x AKG HT50 Hand Held Wireless
	2 x AKG SR80 Lapel Wireless
	4 x TEC Light Weight Skintone Lecture
	4 x Active AR – 133 DI Boxes

Stands

2 x	Round Base Stands
3 x	Tripod - long boom
2 x	Tripod - short boom
2 x	Tripod - heavy base
10 x	Telescopic Boom Stands
3 x	AKG Studio Table Stands
2 x	Telescopic Banquet Stands
4 x	Bose SS1 Telescopic Speaker Stands

Projection Equipment

Main Screen - Brakell Perforated Sound Screen
Mitsubishi projector
EIKI EP! 3500 Data Projector (XGA 1024x768 resolution)

Stage Management System

Console. Mounted stage left (prompt side) with head control set talk back from outstations

Stage sound relay and cast call system

Visual or audio talk back cueing systems to all production outstations.

Plug in head sets available at followspot, control room, lighting bridges, fly gallery and backstage.

Cast call and stage sound relay to all dressing rooms and cast assembly areas.

Warning bell system to foyer and public areas controlled by front of house manager.

Counterweight Line Allocation

Line No.	Distance from	Description Setting line
0	340mm	Main House Curtain
1	465mm	Teaser
2	612mm	Tormentor
3	763mm	Spare
4	918mm	Number One Lighting Bar
10	1806mm	Spare
12	2120mm	Border
13	2264mm	Legs
14	2412mm	Number One Tabbs
15	2560mm	Rear Projection Screen
17	2874mm	Number Two Lighting Bar
21	3460mm	Spare
22	3610mm	Spare
24	3910mm	Border
25	4073mm	Legs
27	4368mm	Number Three Lighting Bar
30	4818mm	Spare
31	4976mm	Spare
33	5268mm	Spare
35	5564mm	Border
36	5718mm	Legs
38	6018mm	Number Four Lighting Bar
42	6637mm	Spare
43	6758mm	Spare
45	7072mm	Spare
46	7222mm	Spare
48	7532mm	Spare
50	7822mm	Border
51	7972mm	Legs
52	8124mm	Number Two Tabbs
53	8274mm	Spare
56	8728mm	Iris Four Lighting Bar
62	9626mm	Spare
63	9774mm	Spare
64	9923mm	Spare
65	10076mm	Cyclorama

Standard Rig

The theatre is hired in a standard configuration for lighting, sound and fly lines. This includes the lighting rig standard colours (red, blue, amber and pink); the stage apron at auditorium floor level with seats in; stage floor colour - theatre grey; stage clean clear and tidy. Any variation to the standard configuration will be made at the hirer's expense and returned to the standard configuration at the hirers expense. The theatre must be informed in writing at least two weeks prior to the bump in of any change you wish to make to the standard rig.

Theatre Usage Guidelines

- Alterations to the structure and fittings of the theatre are prohibited (including painting and drilling of holes into the stage floor). No painting of scenery or equipment is permitted on stage. Glitter may not be used on scenery or costumes.
- Lighting and sound desks to be operated by Country Arts SA staff or persons approved by Country Arts SA by prior arrangement only. The Public Health Authority has set a maximum sound level limit of 105 decibels. Country Arts SA has the authority to enforce this ruling.
- The use of pyrotechnics, smoke machines or naked flames (other than dry ice), will only be permitted with the appropriate South Australian licences, and in the presence of a representative of the South Australian Metropolitan Fire Service which will be at the hirer's expense. No flammable liquids or explosive material may be brought into the premises.
- All rigging of scenery, lighting etc. must comply with Occupational Health, Safety and Welfare Regulations, and Department of Industrial Relations Regulations. Country Arts SA may refuse the use of any scenery, lighting, sound or other equipment. Counterweight flying system is not to be used by persons under the age of eighteen years and only by persons approved by Country Arts SA by prior arrangement.
- Smoking in the theatre is prohibited other than on stage as part of the performance by prior arrangement. No alcohol shall be brought into the premises, other than by prior arrangement. No foodstuffs or liquids may be taken onto the stage, other than as part of the performance by prior arrangement.
- Corridors surrounding the stage must be kept totally clear of all props and scenery at all times. All performers and backstage crew are to enter the theatre via the stage door. Access is not permitted via the theatre foyer. No persons, other than members of the production crew will be permitted in the auditorium and foyer areas during rehearsals.
- The Theatre is fitted with JLG model 20DVL elevated work platforms to assist in rigging and focussing equipment above the stages. The platforms will elevate to 20 feet above stage level (25 foot max working height). People wishing to use these platforms must produce their yellow Operator Training card as issued by the Elevating Work Platform Association of Australia as proof of training, before commencing work on these platforms.

For technical advice please contact the Theatre on 08 8723 8743.

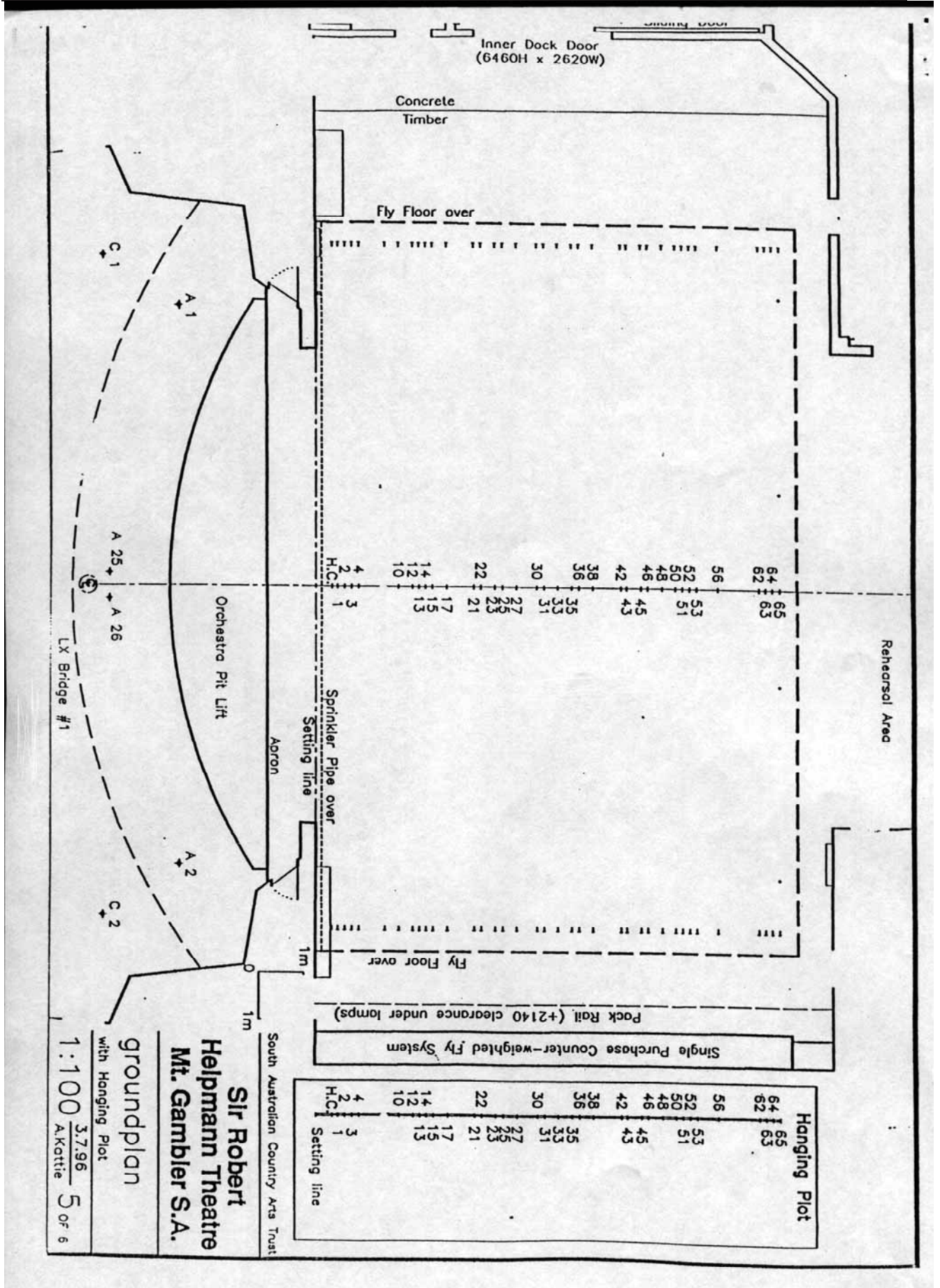

South Australian Country Arts Trust
Sir Robert Helpmann Theatre
Mt. Gambler S.A.
 groundplan
 with Hanging Plot
 1:100 $\frac{3.7.96}{A.Kottie}$ 5 of 6

Sir Robert Helpmann Theatre

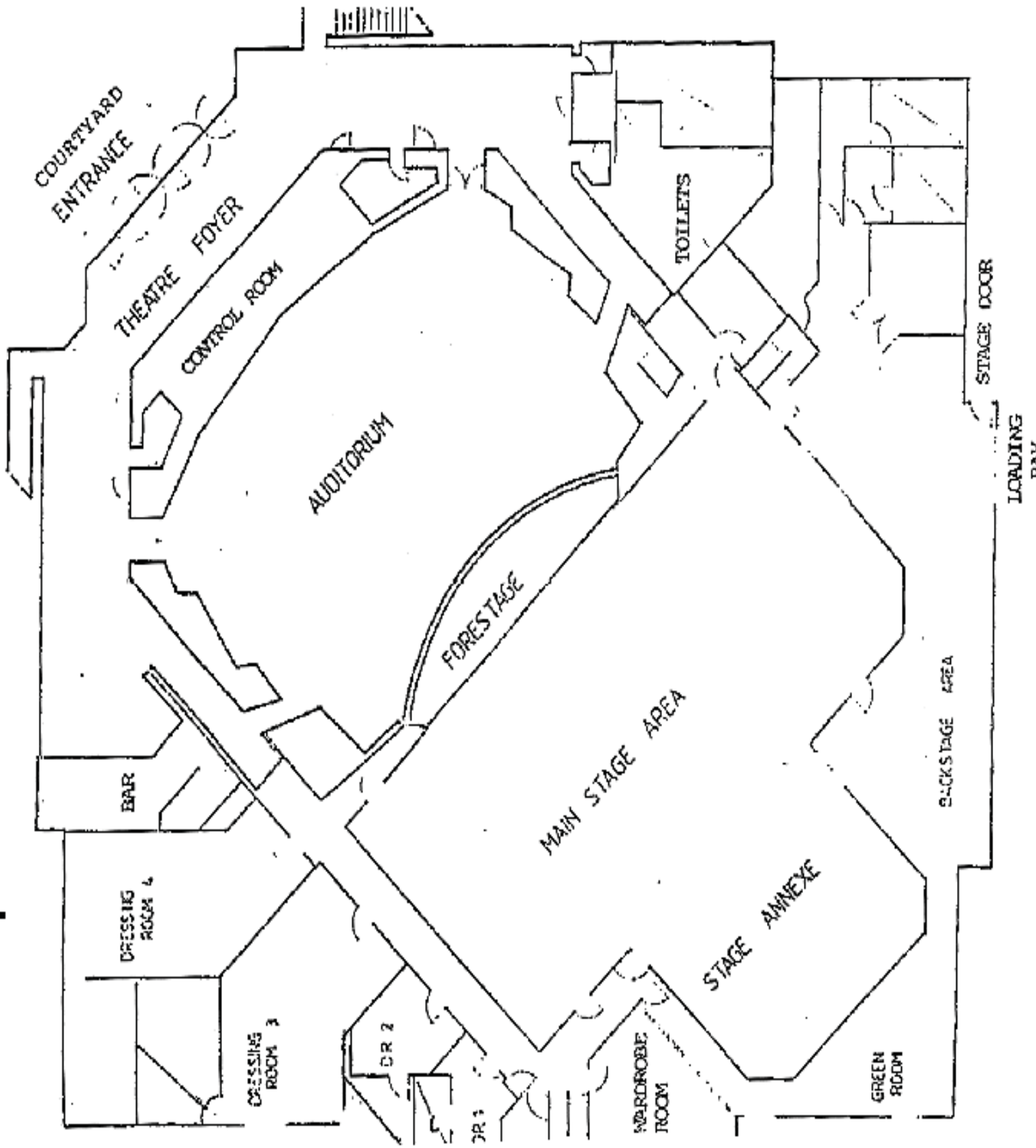

Country Arts SA - Sir Robert Helpmann Theatre - Mount Gambier

LEGEND	
	SELECON 8000V FRESNEL
	STRAND Pat. 743 1000V FRESNEL
	OCT STARLETTE 1000V FRESNEL
	STRAND Pat. 83 500V PROFILE
	STRAND Pat. B13 650V ZOOMSPOT
	STRAND Pat. T64 1000V PROFILE
	STRAND Pat. T64 1000V PROFILE
	DIMMER NUMBER

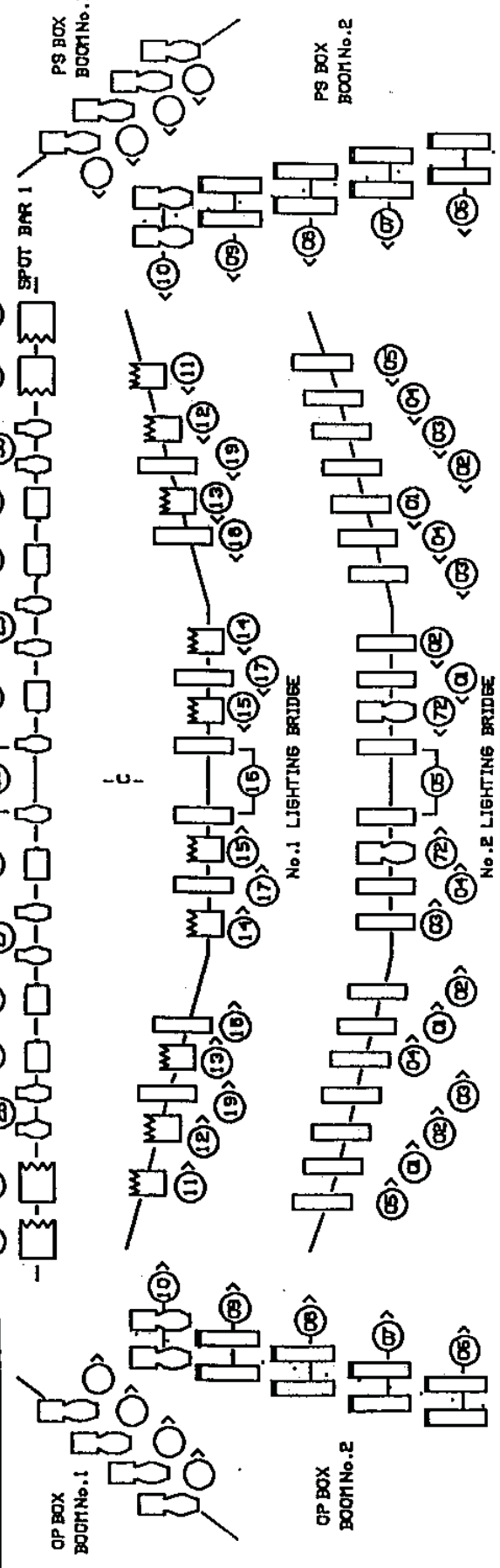
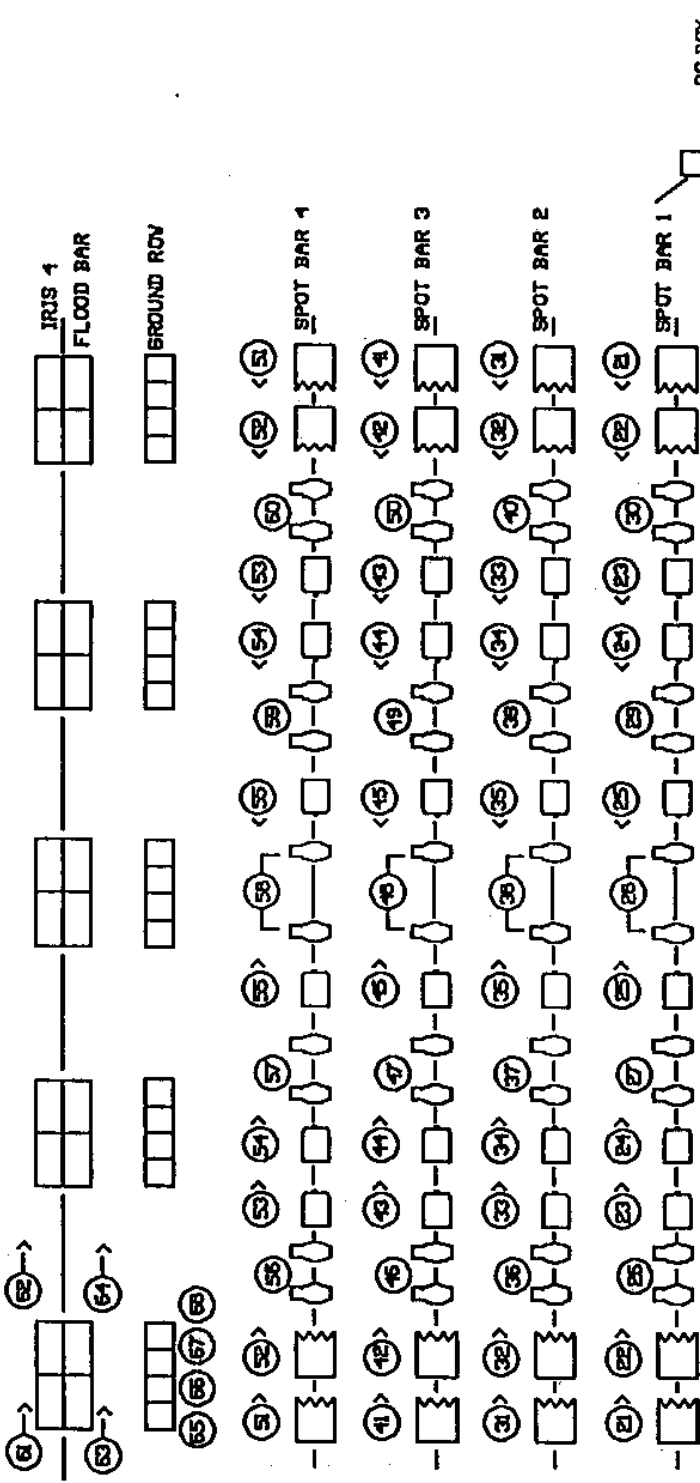

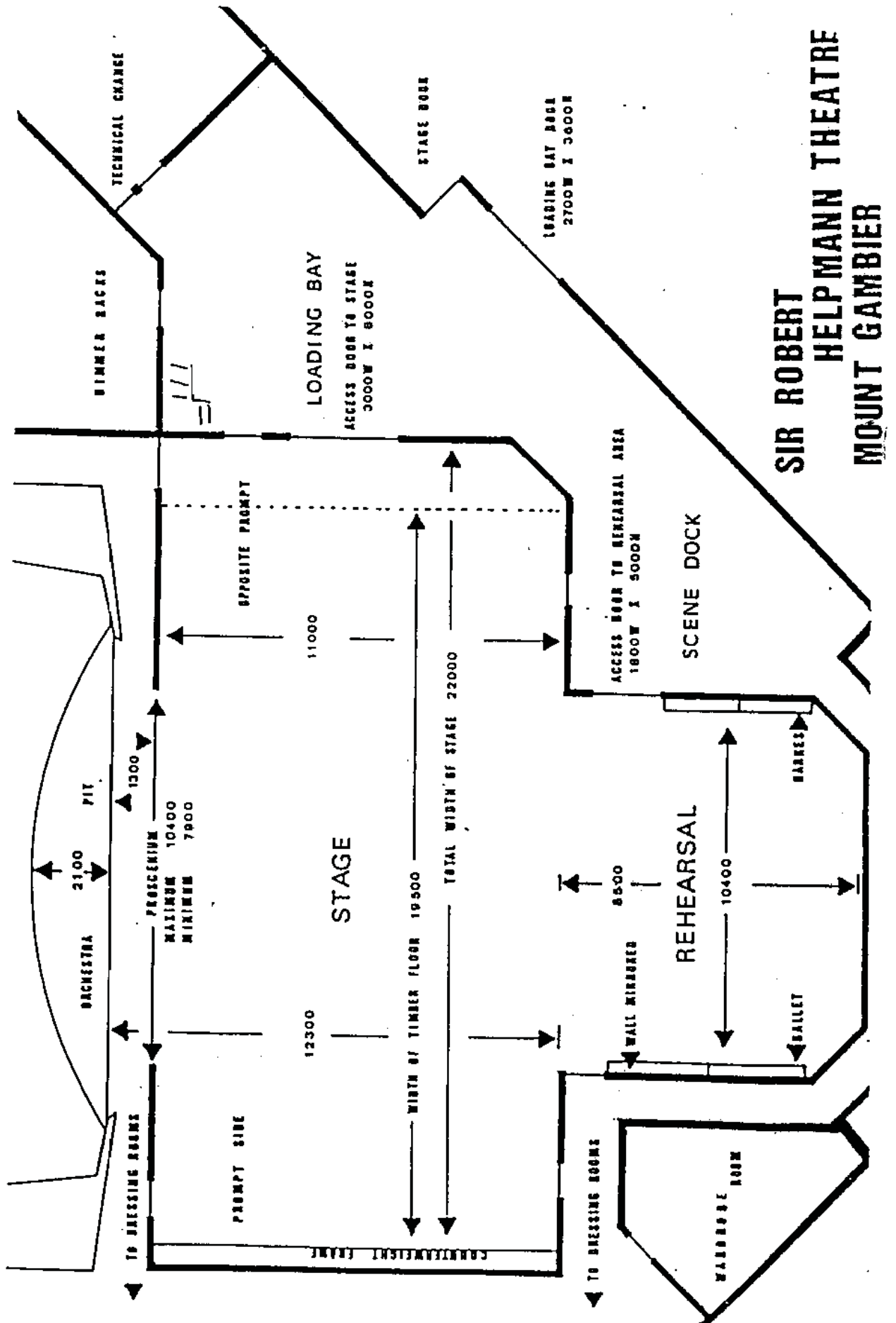

Helpmann Theatre - Seating Plan

